



Fire Safety Signage

Catalogue from Stocksigns Ltd

Material Guide

Standard Materials

Photoluminescent Rigid Plastic and Self Adhesive vinyl



1mm Rigid Plastic

Self Adhesive Vinyl

16swg Aluminium



Bespoke Materials

Foamex

Special Effect
Aluminium Composite

Aluminium Composite



Brushed Stainless Steel

Polycarbonate



Contents

Photoluminescent

3 - 7

Emergency Escape

3 - 4

Fire Fighting Equipment

5

Disabled Access

6

Hazard and General Safety Signs

7

Fire Safety Way-Finding

8

Fire Safety

9 - 12

Framed and Ceiling Mounted

9

Emergency Escape

9 - 11

Disabled Access

11

Hospital Fire Safety

11

Assembly Point Signs

12

Evacuation

12

Mandatory Fire Safety

13 - 25

Fire Door Signs

13

Fire Action Notices

14 - 15

Fire Equipment signs

16 - 19

Fuel Station

20

Fire Hazard & Prohibition

21 - 22

Easy Ordering Guide

Understanding the Code



10 20 30 11090 KD | RG

MATERIAL CODES

This tells you the materials the sign is available in.

e.g: 10 = Aluminium
20 = Rigid Plastic
30 = Self-Adhesive Vinyl

SIZE CODES

These are the sizes that the sign is available in. (See price grids for size identification)

PRODUCT CODE

This is the unique product code for that design.

E.g. This sign in Rigid Plastic, 600 x 200mm: 2011090 RG

How to Order



10 20 30 11090 KD | RG

STEP 1

- Find the sign design you require.
- Note the product code.



10 20 30 11090 KD | RG

STEP 2

- Choose the material you require.
- Use our material guide on the left to select the most suitable material for the job.



10 20 30 11090 KD | RG

STEP 3

- Look at the sizes your sign is available in.
- Use the price grids for size codes.
- Choose the most appropriate size using the installation guide above.



Photoluminescent Fire

BS EN ISO 7010 Standard Signs



Our photoluminescent material is a PSPA (Photoluminescent Safety Products Association) Class B performing product which means it illuminates in the event of fire. Also available from Stocksigns is the PSPA Class C product which if required should be stated at the time of order. This may incur additional cost.

Both materials are suitable for interior and exterior use.

- ▶ White appearance under usual lighting conditions and glows bright green in dark conditions.
- ▶ Flame retardant - Passing all flame, smoke and toxicity tests
- ▶ UV resistant - Enabling use both indoor and outdoor.

Can be used for all escape routes

*



21|31| 16020 GD | MG

*



21|31| 16022 GD | MG

* Only for use in auditoriums or where a revolving door is in use.



21|31| 16000 KD | NF | RG

66| 29781 KD | NF | RG | (Double sided)



21|31| 16005 KD | NF | RG



21|31| 16006 KD | NF | RG



21|31| 16007 KD | NF | RG



21|31| 16004 KD | NF | RG

66| 29780 KD | NF | RG | (Double sided)



21|31| 16009 KD | NF | RG



21|31| 16003 KD | NF | RG

66| 29782 KD | NF | RG | (Double sided)



21|31| 16008 KD | NF | RG

To be used for your Primary (main) escape route only



21|31| 16016 KD | NF | RG



21|31| 16017 KD | NF | RG



21|31| 16010 KD | NF | RG

66| 29784 KD | NF | RG | (Double sided)



21|31| 16015 KD | NF | RG



21|31| 16014 KD | NF | RG

66| 29783 KD | NF | RG | (Double sided)



21|31| 16013 KD | NF | RG

66| 29785 KD | NF | RG | (Double sided)



21|31| 16019 KD | NF | RG



21|31| 16018 KD | NF | RG

Designs to Hospital Technical Memoorandum 65, Guide 2



21|31| 16822 LD | RF



21|31| 16824 LD | RF



21|31| 16819 LD | RF



21|31| 16820 LD | RF



21|31| 16276 LD | RF



21|31| 16821 LD | RF



21|31| 16277 LD | RF



21|31| 16823 LD | RF



21|31| 16818 KD | QF



21|31| 16817 KD | QF

Size in mm	100x100	100x150	150x200	200x100	200x150	200x200	300x70	300x100	350x100
Size code	DD	DF	FG	GD	GF	GG	KA	KD	LD
21 Photolume R Plastic	£3.88	£5.45	£8.30	£6.36	£8.30	£9.51	£6.54	£8.3	£8.66
31 Photolume S/A Vinyl	£2.91	£4.00	£6.42	£4.91	£6.42	£7.45	£5.27	£6.42	£7.99
66 Double-sided Rigid Plastic	-	-	-	-	-	-	-	£16.12	-

Emergency Escape Signs



21|31 16180 KA RD



21|31 16989 KA

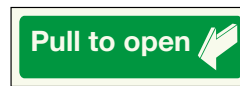

21|31 16187 KD

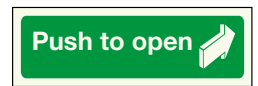

21|31 16186 KD



21|31 16035 KD RG



21|31 16034 KD RG

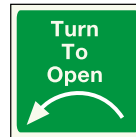

21|31 17693 DD

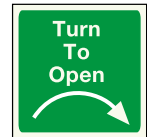

21|31 17692 DD



21|31 16029 GF



21|31 16028 GF



21|31 17677 DF



21|31 17678 DF



21|31 16030 FG



21|31 16031 FG



21|31 16032 FG



21|31 16033 FG

Symbols to BS EN ISO 7010

It is not permissible to use emergency escape signs with text only. The supplementary wording and arrows below can only be used with the running person symbols from BS EN ISO 7010.



21|31 16024 GG MM



21|31 16026 GG MM



21|31 16027 GG MM



21|31 16761 GG MM



21|31 16025 GG MM



21|31 16760 GG MM



21|31 16054 GG MM



21|31 16053 GG MM

	Size in mm	400x200	400x400	450x150	550x150	600x100	600x150	600x200	600x450	685x125
	Size code	MG	MM	NF	QF	RD	RF	RG	RN	TE
21	Photolum R Plastic	£17.32	£32.34	£14.12	£17.50	£12.23	£17.68	£22.23	£50.09	£17.56
31	Photolum S/A Vinyl	£12.72	£17.44	£10.96	£12.96	£9.93	£13.20	£17.62	£21.74	£13.14
66	Double-sided Rigid Plastic	-	-	£28.26	-	-	-	£43.34	-	-

Photoluminescent Fire

Fire Fighting Equipment Signs



Photoluminescent Fire Action Notices



Projecting Fire Equipment Signs

Highly visible from several directions, these signs are designed to be fixed above fire equipment where flat signs would not easily be seen from some angles. Signs are supplied with concealed fixing holes for easy fixing. Size of each sign face is 200 x 300mm.



Fire Equipment Number Markings



REMEMBER

For a satisfactory performance, photoluminescent materials require initial activation from a good light source.

	Size in mm	75x100	75x210	80x80	100x100	150x200	200x150	200x200
	Size code	BD	BH	CC	DD	FG	GF	GG
21	Photolume R Plastic	£3.88	£6.30	£3.88	£3.88	£8.30	£8.30	£9.51
31	Photolume S/A Vinyl	£2.91	£4.85	£2.91	£2.91	£6.42	£6.42	£7.45

Projecting Sign

Fire Exit sign visible from several directions.

For fixing above fire exits. To be used in auditoriums/revolving doors, or in conjunction with other fire exit signs. Manufactured from Rigid Plastic and attached by concealed screw fixings.



66 26693 200mm x 300mm £54.36

Fire Equipment Signs

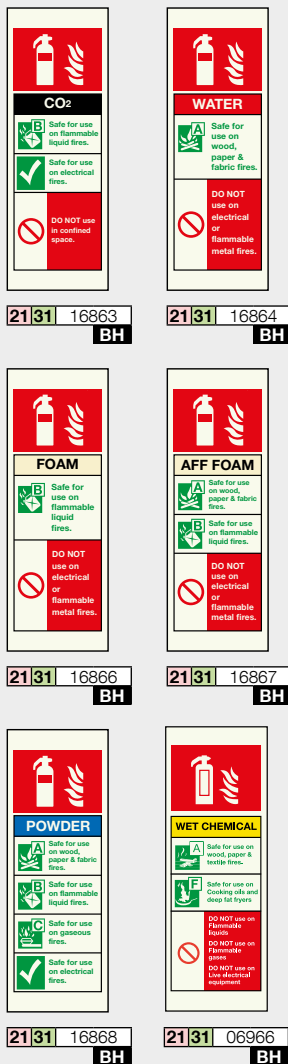

Disabled Access Emergency Escape Signs

Designed to indicate Exit Routes and Refuge Areas for assisting the physically impaired.



21|31 16377 LD RF



21|31 16378 LD RF



21|31 16373 LD RF



21|31 16380 KD



21|31 16381 KD



21|31 16384 JK



21|31 16383 JK



21|31 16382 JK

General Fire Safety Signs



21|31 16835 CC



21|31 16861 CC



21|31 16836 GG

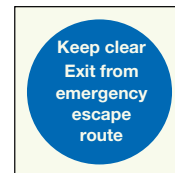

21|31 16837 GG

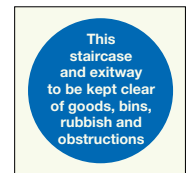

21|31 16838 GG



21|31 16183 BD



21|31 16181 BD



21|31 16178 BD



21|31 16182 BD



21|31 16184 BD



21|31 16185 BD



21|31 16869 BH



21|31 13706 BH



21|31 16043 DD GG MM



21|31 16042 DD GG MM

* All BD, CC, DB & DD sizes now come with self-adhesive backing FREE or holes on request.

	Size in mm	200x250	250x300	300x100	300x400	350x100	400x400	600x150
	Size code	GJ	JK	KD	KM	LD	MM	RF
21	Photolume R Plastic	£11.87	£15.32	£8.30	£22.23	£8.66	£32.34	£17.68
31	Photolume S/A Vinyl	£9.69	£11.75	£6.42	£17.62	£7.99	£17.44	£13.20

Photoluminescent Safety

Hazard Symbols



21|31|17748 DD GG



21|31|17749 DD GG



21|31|17750 DD GG



21|31|17751 DD GG

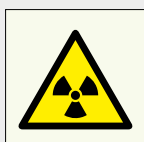

21|31|17747 DD GG

General Fire and Safety Signs



21|31|16850 KD



21|31|16853 KD



21|31|16857 KD



21|31|16858 KD



21|31|16839 KD



21|31|16844 KD



21|31|17745 KD



21|31|16848 KD



21|31|16847 KD



21|31|16852 KD



21|31|16854 KD



21|31|16840 KD



21|31|16842 KD



21|31|16843 KD



21|31|17746 KD



21|31|16849 KD



21|31|16851 KD



21|31|16856 KD



21|31|16855 KD



21|31|16841 KD



21|31|16845 KD



21|31|16846 KD



21|31|16278 KD

Hazard Signs



21|31|17752 FG GJ



21|31|17753 FG GJ



21|31|17756 FG GJ



21|31|17757 FG GJ



21|31|17758 FG GJ



21|31|17759 FG GJ



21|31|17754 FG GJ



21|31|17755 FG GJ

Size in mm		100x100	150x200	200x200	200x250	250x200	300x100	600x200
Size code		DD	FG	GG	GJ	JG	KD	RG
21	Photolume R Plastic	£3.88	£8.30	£9.51	£11.87	£6.42	£8.30	£22.23
31	Photolume S/A Vinyl	£2.91	£6.42	£7.45	£9.69	£9.75	£6.42	£17.62

Wayfinding Signs

Way-finding signage is an essential part of the Regulatory Reform (Fire Safety) Order 2005 to ensure fire fighters can safely and effectively navigate high-rise buildings in emergency situations.

Standard Designs Available



Floor Identification

Width: 450mm
Height: 450mm

10 20 21 5042 450 x 450mm

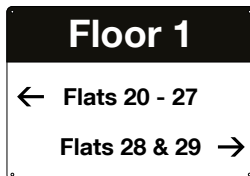

Flat Indicator

Width: 450mm
Height: 315mm

10 20 21 5043 450 x 315mm

Floor Directory	
Floor 0	Flats 1 - 8
Floor 1	Flats 9 - 13
Floor 2	Flats 14 - 19
Floor 3	Flats 20 - 24
Floor 4	Flats 25 - 30
Floor 5	Flats 31 - 36
Floor 6	Flats 37 - 41
Floor 7	Flats 42 - 45

Floor Directory

Width: 700mm
Height: Dependant on content

Material Options



22swg Aluminium



1mm Rigid Plastic



Photoluminescent
Rigid Plastic

*All supplied with radius
corners and holes*

Need bespoke signage?

Bespoke and branded signage is available on request. Signage must comply with the Regulatory Reform (Fire Safety) Order 2005 but this does allow for branding and different sizes.

Call the team to get started on 01737 774072

Photoluminescent Floor Markers

Photoluminescent floor markers will assist with orientation during evacuation, and enhance your overall way guidance system. These signs will adhere to most clean, smooth floor surfaces and are ideal for reinforcing your safety policy.

This product is not suitable for external use.

Sold in packs of 10



80mm diameter:

66 26063 Vinyl £42.65

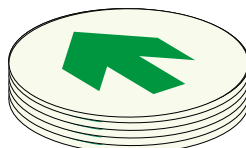

80mm diameter:

66 20784 Vinyl £42.65

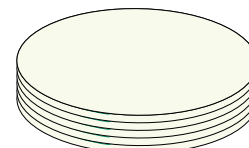

80mm diameter:

66 20782 Vinyl £42.65

Fire Safety

Wall and Ceiling Mounted Emergency Escape Signs

Wall Mounted



Double sided



60 06253 300mm x 100mm £16.50

60 06254 450mm x 150mm £22.50

60 06255 600mm x 200mm £29.50

Double sided



60 06256 300mm x 100mm £16.50

60 06257 450mm x 150mm £22.50

60 06258 600mm x 200mm £29.50

Double sided



60 06259 300mm x 100mm £16.50

60 06260 450mm x 150mm £22.50

60 06261 600mm x 200mm £29.50

WALL MOUNTED

Ceiling Mounted



Double sided



60 06265 300mm x 100mm £16.50

60 06266 450mm x 150mm £22.50

60 06267 600mm x 200mm £30.60

Single sided



60 06262 300mm x 100mm £16.50

60 06263 450mm x 150mm £22.50

60 06264 600mm x 200mm £30.60

Single sided



60 06687 300mm x 100mm £16.50

60 06688 450mm x 150mm £22.50

60 06689 600mm x 200mm £30.60

CEILING MOUNTED

Aluminium Suspended Frame



66 23523 450 x 150mm £39.45

66 26149 600 x 200mm £45.20

Includes pair of suspension wires and ceiling clips

Compatible Signs

Frame size refers to the internal signage area, with the frame being open on both sides for use with double sided fire signs.

Frame 450 x 150mm is to be used with **NF** size signs

Frame 600 x 200mm is to be used with **RG** size signs

See page 2 for double sided photoluminescent signs and page 9 for standard double sided fire signs.

Additional Fixings

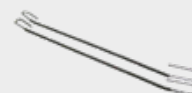

66 26587 Suspension Wire £1.15



66 26588 Pair of Ceiling Clips £0.95

Prestige Fire Exit Signs

Size: 450 x 150mm

Material: Stainless Steel

Finishing: Supplied with screw holes



60 06704 S/Steel £27.41



60 06705 S/Steel £27.41



60 06703 S/Steel £27.41



60 06706 S/Steel £27.41

British Standard Signs

Can be used for all escape routes.



10 20 30 11097 KD | NF | RG



10 20 30 11090 KD | NF | RG
60 27916 KD | NF | RG (Double sided)



10 20 30 11096 KD | NF | RG



10 20 30 11095 KD | NF | RG
60 27915 KD | NF | RG (Double sided)



10 20 30 11099 KD | NF | RG



10 20 30 11094 KD | NF | RG
60 27917 KD | NF | RG (Double sided)



10 20 30 11100 KD | NF | RG



10 20 30 11098 KD | NF | RG

To be used for your Primary (main) escape route only.



10 20 30 11109 KD | NF | RG
60 27679 KD | NF | RG (Double sided)



10 20 30 11119 KD | NF | RG



10 20 30 11121 KD | NF | RG



10 20 30 11107 KD | NF | RG
60 27681 KD | NF | RG (Double sided)



10 20 30 11120 KD | NF | RG



10 20 30 11122 KD | NF | RG



10 20 30 11101 KD | NF | RG
60 27680 KD | NF | RG (Double sided)



10 20 30 11118 KD | NF | RG



10 20 30 11130 GD | MG



10 20 30 11129 GD | MG

Projecting Signs

For fixing next to fire exits making it visible from several directions. Manufactured from rigid plastic and attached by concealed screw fixings (supplied). Please note, you will also need a sign above the door.



60 26653 200mm x 300mm £28.30

* Only for use in auditoriums or where a revolving door is in use.

Size in mm	75x210	80x80	150x150	150x200	200x100	250x500	300x100	400x200	450x150	600x200	600x450
Size code	BH	CC	FF	FG	GD	JP	KD	MG	NF	RG	RN
10 Aluminium	£5.51	£3.15	£6.90	£7.57	£4.48	£18.90	£7.57	£16.29	£13.75	£18.59	£34.76
20 Rigid Plastic	£3.27	£1.94	£3.94	£4.42	£2.91	£11.87	£4.42	£9.02	£7.63	£11.45	£21.44
30 Self Adhesive Vinyl	£1.76	£1.39	£2.12	£2.73	£1.70	£7.27	£2.73	£5.94	£4.97	£7.27	£10.90
60 Double-sided Rigid Plastic	-	-	-	-	-	-	£8.62	-	£14.92	£22.89	-

Fire Safety

Extra Large Directional Emergency Escape Signs

These signs give a much extended viewing range (up to 40 metres) due to their size, making them especially suitable for use in areas such as sports halls, stadiums, department stores and other open plan areas.

Symbols to BS EN ISO 7010.



60 26676 1200mm x 400mm £38.85 Single sided (arrow left)

60 26678 1200mm x 400mm £38.85 Single sided (arrow right)

60 26679 1200mm x 400mm £38.85 Double sided (with arrow)

60 26677 1200mm x 400mm £38.85 Single sided (arrow up)



60 26684 800mm x 400mm £27.20

Single sided (No arrow)

♦ Only for use in auditoriums or where a revolving door is in use.



Extended viewing range with extra large signs.

Disabled Access Emergency Escape Signs

Designed to indicate Exit Routes and Refuge Areas for assisting the physically impaired.



10 20 30 11202 GG MM



10 20 30 11167 JK



10 20 30 11181 JK



10 20 30 11105 JK



10 20 30 11124 LD RF



10 20 30 11159 LD RF



10 20 30 11163 LD RF



10 20 30 03577 LD RF



10 20 30 11165 KD



10 20 30 11164 KD



10 20 30 03578 KD



10 20 30 03579 KD

Designs to Hospital Technical Memorandum 65, Signs Guide 2

Based on the designs of BS 5499 but with the addition of the flame symbol to enhance the meaning of the signs. Tests have shown the inclusion of the flame symbol significantly assists in recognition and understanding of the meaning of the escape symbol.



10 20 30 12210 LD RF



10 20 30 19786 LD RF



10 20 30 19787 LD RF



10 20 30 12207 LD RF



10 20 30 12208 LD RF



10 20 30 12212 LD RF



10 20 30 12209 LD RF



10 20 30 12211 LD RF



10 20 30 12206 KD QF



10 20 30 12205 KD QF

Supplementary Texts and Directional Arrows

The following signs (*) MUST be accompanied by a RUNNING PERSON exit pictogram as shown here.



10 20 30 12204 GG MM



10 20 30 11138 GG MM



10 20 30 12203 GG MM



10 20 30 11126 GG MM



10 20 30 12200 GG MM



10 20 30 12201 GG MM



10 20 30 11127 GG MM



10 20 30 11134 GG MM

	Size in mm	75x100	100x100	100x150	150x100	200x200	250x300	300x70	300x100	300x250
	Size code	BD	DD	DF	FD	GG	JK	KA	KD	KJ
10	Aluminium	£3.15	£3.15	£4.48	£4.48	£9.93	£16.17	£6.18	£7.57	£16.17
20	Rigid Plastic	£1.94	£1.94	£2.91	£2.91	£5.51	£8.54	£3.57	£4.42	£8.54
30	Self Adhesive Vinyl	£1.39	£1.39	£1.70	£1.70	£3.63	£5.63	£2.12	£2.73	£5.63



10 20 30 12202 GG MM



10 20 30 11133 GG MM

Assembly Point Signs

This style, (see photo) which uses a symbol that complies with BS EN ISO 7010, is more appropriate for indicating an **ASSEMBLY POINT**. Available in a range of materials, with the option of wall or post mounting (please state which you require on your order). When ordering these signs with the letters and numbers shown here, please use the code followed by the appropriate letter or number, and type of mounting.

Example **10|11935 JK /B**

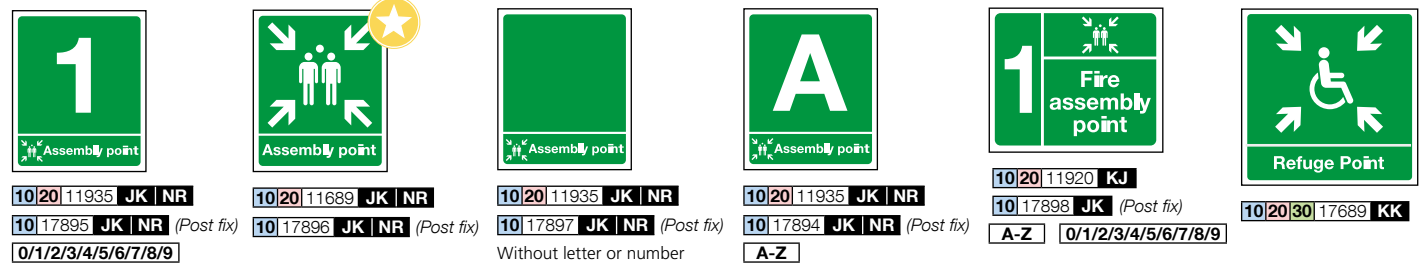
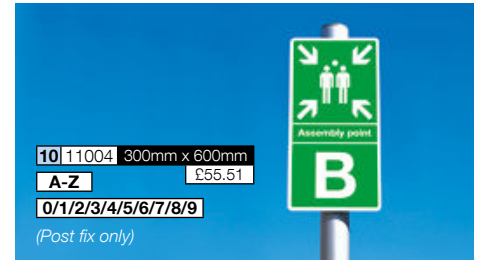

Evacuation Signs

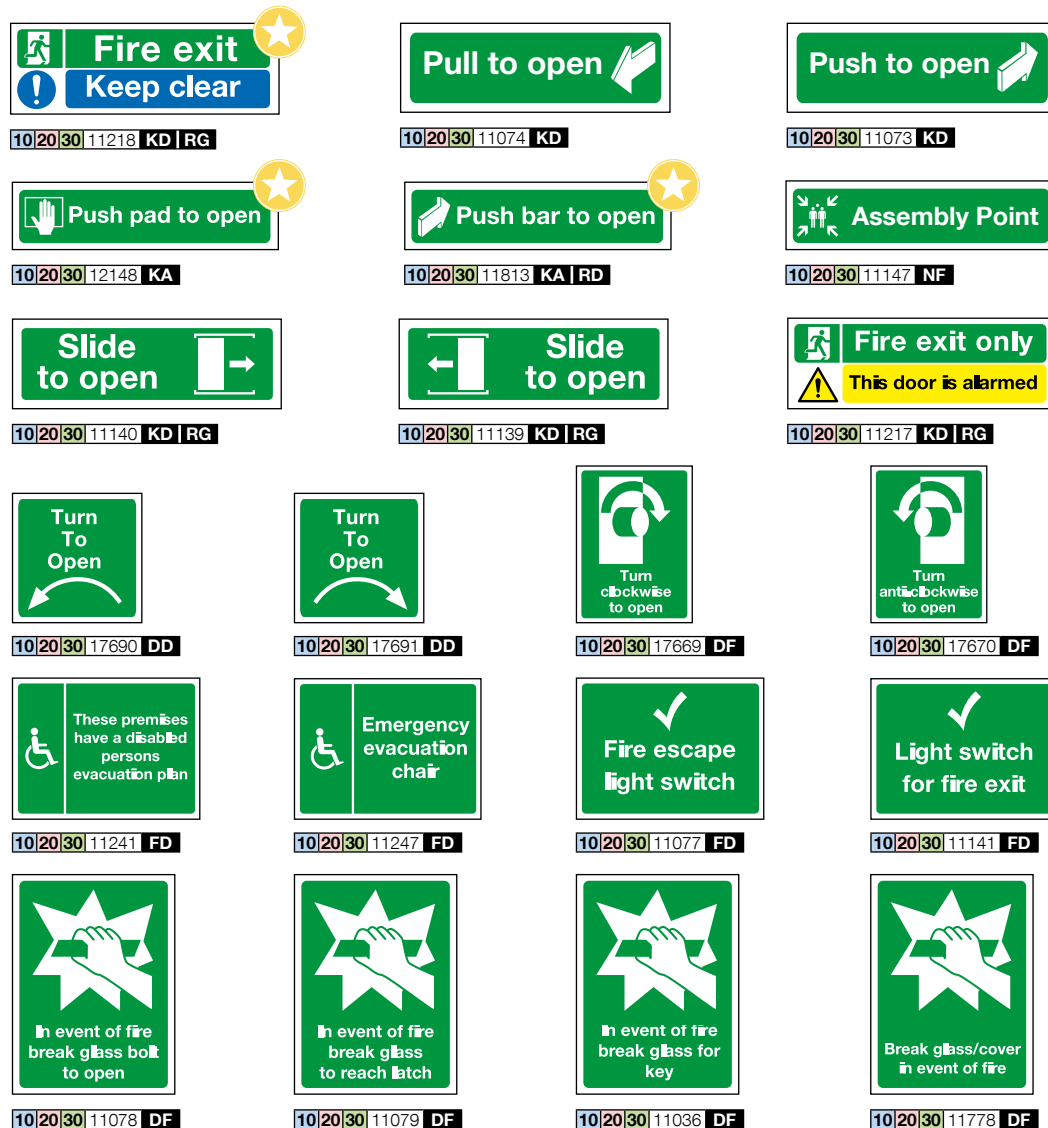

* Only for use in auditoriums or where a revolving door is in use.

Size in mm	300x300	350x100	400x400	450x150	450x600	550x150	600x100	600x150	600x200
Size code	KK	LD	MM	NF	NR	QF	RD	RF	RG
10 Aluminium	£17.14	£8.30	£23.86	£13.75	£34.76	£16.39	£14.41	£17.08	£18.59
20 Rigid Plastic	£10.05	£4.66	£14.17	£7.63	£21.44	£9.33	£6.84	£10.05	£11.45
30 Self Adhesive Vinyl	£6.06	£2.79	£8.72	£4.97	£10.90	£6.00	£4.54	£6.06	£7.27

Extendable Assembly Point Signs



Easy to move, double sided and extending fire assembly point signs in rigid plastic. Ideal for any premises that have no clear area to use as a regular assembly point.

Company names and logos can be included at a small extra cost. Please contact our sales team for further information.

Sign size: 300mm x 600mm

60|27893 Rigid Plastic Sign £63.95
Includes pole and sign

Mandatory Fire Safety

Prestige Fire Signs



60	26577	Brass Effect	£8.45
60	26578	S/Steel	£8.45
60	27883	Anodised Ali	£6.70

Stainless steel, Brass effect composite (ACM) and anodised aluminium to give a superior finish.

With symbols conforming to BS EN ISO 7010, signs are supplied with self-adhesive backing as standard.



60	23700	Brass Effect	£8.45
60	23701	S/Steel	£8.45
60	23702	Anodised Ali	£6.70



60	29100	Brass Effect	£8.45
60	29101	S/Steel	£8.45
60	29102	Anodised Ali	£6.70



60	26658	Brass Effect	£8.45
60	26659	S/Steel	£8.45
60	27887	Anodised Ali	£6.70



60	26656	Brass Effect	£8.45
60	26657	S/Steel	£8.45
60	27884	Anodised Ali	£6.70



60	26545	Brass Effect	£9.12
60	26546	S/Steel	£8.90
60	27882	Anodised Ali	£8.98



60	26664	Brass Effect	£9.77
60	26665	S/Steel	£9.77
60	27889	Anodised Ali	£7.75



60	26666	Brass Effect	£9.77
60	26667	S/Steel	£9.77
60	27890	Anodised Ali	£7.75



60	26662	Brass Effect	£9.77
60	26663	S/Steel	£9.77
60	27891	Anodised Ali	£7.75



60	26674	Brass Effect	£9.77
60	26675	S/Steel	£9.77
60	27892	Anodised Ali	£7.75

Mandatory Fire Prevention Signs

The Building Regulations 2010 recommends that doors designed as fire-resisting should be marked with the appropriate fire safety sign.



10	20	30	11025	CC
----	----	----	-------	----

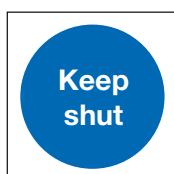

10	20	30	17732	CC
----	----	----	-------	----

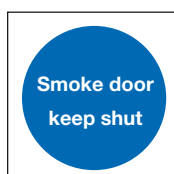

10	20	30	14322	CC
----	----	----	-------	----



10	20	30	11046	CC
----	----	----	-------	----



10	20	30	11026	CC
----	----	----	-------	----



10	20	30	11045	CC
----	----	----	-------	----



10	20	30	11779	CC
----	----	----	-------	----

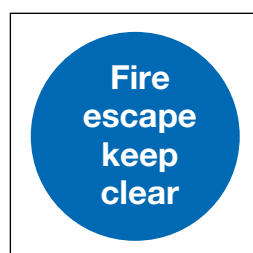

10	20	30	11132	GG	MM
----	----	----	-------	----	----

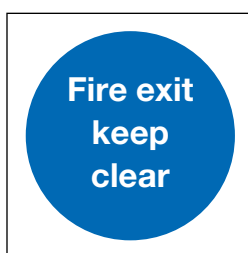

10	20	30	11131	GG	MM
----	----	----	-------	----	----



All CC sizes come with Self-adhesive backing

Size in mm	80x80	200x250	400x300
Size code	CC	GG	MM
10 Aluminium	£3.15	£9.93	£23.86
20 Rigid Plastic	£1.94	£5.51	£14.17
30 Self Adhesive Vinyl	£1.39	£3.63	£8.72

General Fire Action Notices

Our standard fire action notices contain several texts which are in common use but may not be appropriate for all circumstances. If these texts do not meet your requirements, please call our **Sales Team on 01737 774077**.

We are also able to add your own details in the 'write-on areas' of standard fire action signs at additional cost.

For use in blocks of flats

Fire Action

The fire procedures for your block are based upon a "stay put if safe" strategy.
People need only evacuate areas that have fire or smoke.

IF YOU DISCOVER A FIRE IN YOUR FLAT

1. Leave at once shutting the doors behind you.

2. Leave the building by the nearest and safest route.

3. Telephone the Fire Brigade by dialling "999" or "112" and give your address and postcode.

Wait for the Fire Brigade to arrive. Do not re-enter the building.

IF YOU ARE SAFELY WITHIN YOUR FLAT & THERE IS A FIRE ELSEWHERE IN THE BLOCK

You should be safe to stay in your flat keeping the doors and windows closed.

On arrival the Fire Brigade will make an assessment and will assist with evacuation if required.

If you wish to evacuate, leave closing doors behind you and exit the building.

IF YOU ARE IN A COMMUNAL AREA & BECOME AWARE OF A FIRE

Leave the building at once & alert the Fire Brigade by telephoning "999" or "112".

IF LEAVING THE BUILDING PLEASE

• Do NOT use lifts (unless this has specifically been agreed in a Personal Emergency Evacuation Plan).

• Do NOT re-enter the building until instructed to do so.

Your Assembly Point is: _____

GJ3882-0

10/20/30 05093 JK

For use in buildings with lifts

Fire action

IF YOU DISCOVER A FIRE

1. Immediately operate nearest alarm call-point.
2. Attack fire, if possible, with appliances provided but without taking personal risks.

ON HEARING ALARM OF FIRE

3. The _____ will call the Fire Brigade immediately by EXCHANGE TELEPHONE
- (a) Lift receiver and dial '999'.
- (b) Give operator your telephone number and ask for FIRE.
- (c) When Fire Brigade replies give call distinctly FIRE AT _____

DO NOT REPLACE RECEIVER UNTIL ADDRESS HAS BEEN REPEATED BY FIRE BRIGADE

CALL FIRE BRIGADE IMMEDIATELY TO EVERY FIRE OR ON SUSPICION OF FIRE

4. Leave building and report to person in charge of assembly point. _____
- USE NEAREST AVAILABLE EXIT

DO NOT USE LIFT
DO NOT STOP TO COLLECT PERSONAL BELONGINGS
DO NOT RE-ENTER BUILDING

10/20/30 11032 JK

For use in buildings without lifts

Fire action

IF YOU DISCOVER A FIRE

1. Immediately operate nearest alarm call-point.
2. Attack fire, if possible, with appliances provided but without taking personal risks.

ON HEARING ALARM OF FIRE

3. The _____ will call the Fire Brigade immediately by EXCHANGE TELEPHONE.
- (a) Lift receiver and dial '999'.
- (b) Give operator your telephone number and ask for FIRE.
- (c) When Fire Brigade replies give call distinctly FIRE AT _____

DO NOT REPLACE RECEIVER UNTIL ADDRESS HAS BEEN REPEATED BY FIRE BRIGADE

CALL FIRE BRIGADE IMMEDIATELY TO EVERY FIRE OR ON SUSPICION OF FIRE

4. Leave building and report to person in charge of assembly point. _____
5. The _____ will take charge of any evacuation and ensure that no one is left in the building.
- USE NEAREST AVAILABLE EXIT

DO NOT STOP TO COLLECT PERSONAL BELONGINGS
DO NOT RE-ENTER BUILDING

10/20/30 11033 JK

For use near a telephone operator

Fire action

Fire Action

Any person discovering a fire

- 1 Sound the alarm
- 2 _____ to call the fire brigade
- 3 Attack the fire if possible using the appliances provided

On hearing the fire alarm

- 4 Leave the building by _____ route
- 5 Close all doors behind you
- 6 Report to assembly point _____

Do not take risks

Do not return to the building for any reason until authorised to do so

10/20/30 11188 GJ

	Size in mm	200x250	250x200	250x300	400x300	600x450
	Size code	GJ	JG	JK	MK	RN
10	Aluminium	£12.36	£12.36	£16.17	£18.59	£34.76
20	Rigid Plastic	£6.42	£6.42	£8.54	£11.43	£21.44
30	Self Adhesive Vinyl	£4.54	£4.54	£5.63	£7.27	£10.90

Mandatory Fire Safety

Fire Action Notices for the Disabled Access

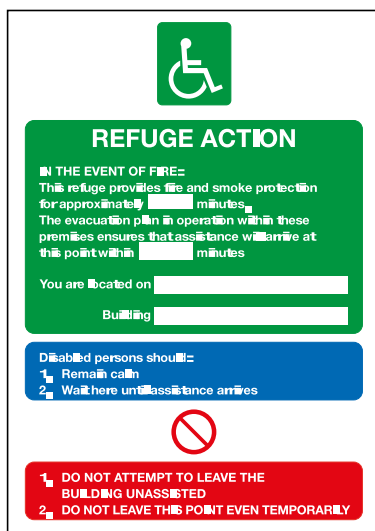

10/20/30 17090 JK

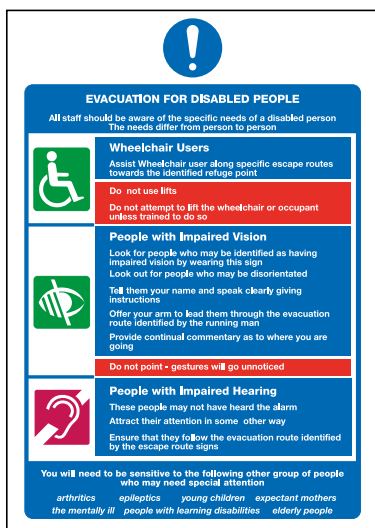

10/20/30 17091 JK

Fire Action Signs for Staff

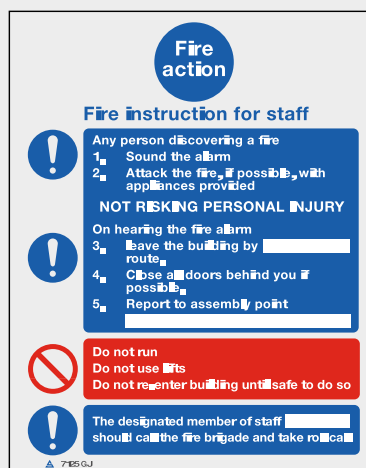

10/20/30 17125 GJ

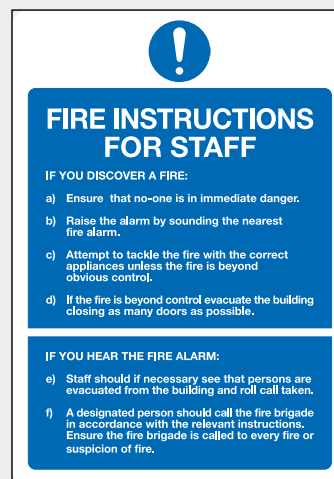

10/20/30 11082 HK

Bespoke Fire Action Notices



Different applications can require different messaging which is why we offer bespoke fire action notices.

Get in touch with the team for a quote for a bespoke sign.

Customisation can include:

- Custom messaging
- Branding
- Alternative materials
- Alternative sizes

Fire Action for Car Parks

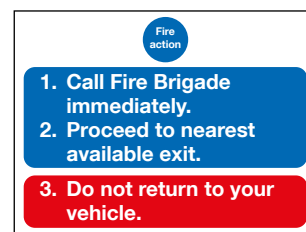

10/20/30 11538 MK | RN

	Size in mm	200x200	200x250	250x300
	Size code	GG	GJ	JK
10	Aluminium	£9.93	£12.36	£16.17
20	Rigid Plastic	£5.51	£6.42	£8.54
30	Self Adhesive Vinyl	£3.63	£4.54	£5.63

Fire Safety Equipment Signs

Fire Fighting Equipment

Clearly identify your fire fighting equipment.

These signs contain symbol designs which conform to BS EN ISO 7010. These standards require the location of all fire fighting equipment to be marked in RED.

Available in Aluminium (10 series), Rigid Plastic (20 series), Self-Adhesive Vinyl (30 series) and Photoluminescent. These signs allow easy identification of the location of fire fighting equipment. Please call our **Sales Team on 01737 774077** if you require any advice on the use of these signs.



10|20|30 17127 GF

In order to fulfil your legal obligations it is a requirement to display the details of your designated fire marshals.

Our range allows for names, photographs and their location within the building to be included.



10|20|30 17095 GF



10|20|30 17096 GF



10|20|30 17128 GF



10|20|30 17127 GF



10|20|30 17126 GF



10|20|30 17129 GF



10|20|30 11051 DB | GF



10|20|30 11629 KM | FG



10|20|30 03572 KM | FG



10|20|30 11049 KM | FG



10|20|30 06967 GG



10|20|30 11158 GG



10|20|30 17093 GF



10|20|30 17094 GF



10|20|30 11072 GF | KJ



10|20|30 11011 MK



10|20|30 12189 GF



10|20|30 12188 GF



10|20|30 12401 GF



10|20|30 12190 GF



10|20|30 11080 GF



10|20|30 11047 GF



10|20|30 11054 KD



10|20|30 11060 KD | NF



10|20|30 11037 KD | NF



10|20|30 11057 KD | NF



10|20|30 11058 KD | NF



10|20|30 11059 KD | NF



10|20|30 11038 KD | NF

Preferred arrow design from BS 5499 part 1, 2002 for use with fire equipment signs when directions to location are necessary.



10|20|30 11644 JD | PG

Size in mm	80x80	100x75	100x100	150x150	150x200	200x150	200x200	250x100
Size code	CC	DB	DD	FF	FG	GF	GG	JD
10 Aluminium	£3.15	£3.15	£3.15	£6.90	£7.57	£7.57	£9.93	£7.27
20 Rigid Plastic	£1.94	£1.94	£1.94	£3.94	£4.42	£4.42	£5.51	£4.18
30 Self Adhesive Vinyl	£1.39	£1.39	£1.39	£2.12	£2.73	£2.73	£3.63	£2.30

Fire Safety Equipment Signs

Fire Fighting Equipment



10|20|30 11053 DB|GF



10|20|30 11051 DB|GF



10|20|30 11085 GF



10|20|30 11052 DB|GF



10|20|30 12402 GF



10|20|30 03575 KM|FG



10|20|30 11081 KM|FG



10|20|30 11628 KM|FG



10|20|30 11068 KM|FG



10|20|30 11048 KM|FG



10|20|30 11626 KM|FG



10|20|30 11089 KM|FG



10|20|30 11627 KM|FG



10|20|30 11050 KM|FG



10|20|30 11062 KD|NF



10|20|30 11063 KD|NF



10|20|30 11117 GG



10|20|30 11171 GG



10|20|30 11065 GG



10|20|30 14977 GG



10|20|30 14983 GG



10|20|30 11066 GG



10|20|30 14902 GG



10|20|30 14980 GG



10|20|30 03574 GG



10|20|30 11155 CC|GG



10|20|30 17004 GG



10|20|30 03573 GG



10|20|30 17130 GG



10|20|30 11067 DD



10|20|30 11069 FF



10|20|30 11070 FF

	Size in mm	300x100	300x250	300x400	400x300	400x600	450x150	500x200
	Size code	KD	KJ	KM	MK	MR	NF	PG
10	Aluminium	£7.57	£16.17	£18.59	£18.59	£32.83	£13.75	£17.62
20	Rigid Plastic	£4.42	£8.54	£11.45	£11.45	£20.35	£7.63	£10.78
30	Self Adhesive Vinyl	£2.73	£5.63	£7.27	£7.27	£9.57	£4.97	£6.60

Fire Safety Equipment Signs

Hydrant Plates

Hydrant plates supplied with Figures as required. Please provide details of the pipe diameter for the top section and the distance to the hydrant for the bottom section.

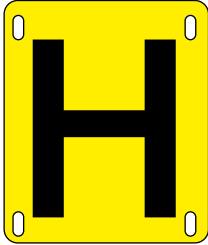

10 21042 178mm x 203mm £14.40

Projecting Fire Equipment Signs

Highly visible from several directions, these signs are designed to be fixed above fire equipment where flat signs would not easily be seen from some angles.

Signs are supplied with concealed fixing holes allowing easy fixing using only four screws. Size of each sign face is 200 x 300mm.



60 26754 £31.70



60 26650 £31.70



60 26651 £31.70



60 26753 £31.70



60 26652 £31.70

Fire Extinguisher Location Panels

Manufactured from 16swg aluminium, these fire extinguisher location panels both identify the extinguisher and give a visual warning as to when the extinguisher has been used and not replaced.

This signage solution is easily fixable with your existing fire extinguisher brackets. Alternative brackets should be sourced from your extinguisher supplier.

Extinguishers are not included.



10 12196 600mm x 900mm £116.40

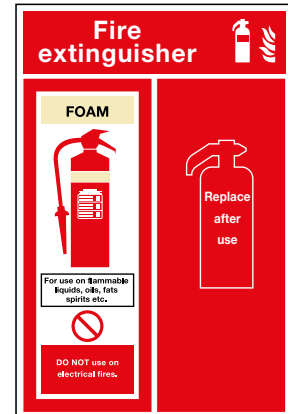

10 12197 600mm x 900mm £116.40

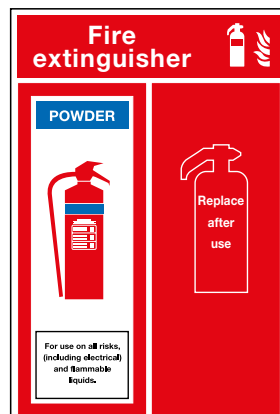

10 12198 600mm x 900mm £116.40

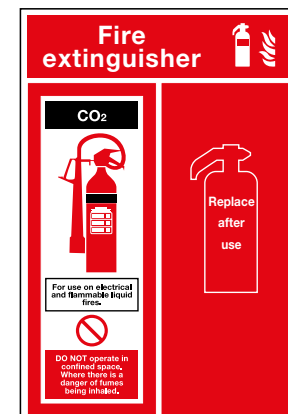

10 12199 600mm x 900mm £116.40

Fire Safety Equipment Signs

Fire Extinguisher Identification to BS EN3 and BS 7863

Under BS EN 3 operative from the 1st January 1997, all new certified fire extinguishers used in European union countries must feature red bodies. In line with familiar uk practice, BS 7863 allows manufacturers to affix coloured identification panels on or above the operating instructions covering no more than 5% of the body surface area and visible through a horizontal arc of 180 degrees when the extinguisher is mounted. The signs featured immediately below reflect the regulations.



10 20 30 11782 BH

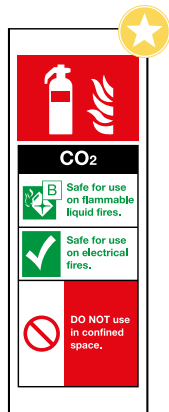

10 20 30 11781 BH



10 20 30 13706 BH



10 20 30 11785 BH



10 20 30 11784 BH



10 20 30 11786 BH



10 20 30 17097 BH

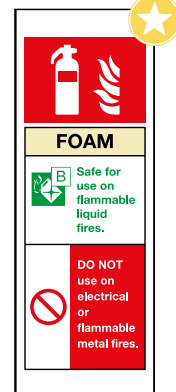

10 20 30 11783 BH

Additional Fire Extinguisher Designs



10 17005 FG



10 17006 310mm x 900mm £15.40



10 20 30 17734 FG KM



10 20 30 17735 FG KM



10 20 30 03576 FG KM



10 20 30 17736 FG KM



10 20 30 17737 FG KM

Size in mm	75x210	150x200	210x210	300x200	300x400	450x600	600x400
Size code	BH	FG	HH	KG	KM	NR	RM
10 Aluminium	£5.51	£7.57	£10.96	£14.41	£18.59	£34.76	£32.83
20 Rigid Plastic	£3.27	£4.42	£6.00	£6.84	£11.45	£21.44	£20.35
30 Self Adhesive Vinyl	£1.76	£2.73	£4.00	£4.54	£7.27	£10.90	£9.57

Fire Safety Equipment Signs

Fuel Station and Hazard Signs

Combination message signs for use in garage forecourts or areas with a potentially hazardous environment.

Size: 200mm x 800mm

Prices:

10	£18.60
20	£14.20
30	£8.70

10 20 30 13680

10 20 30 13681

10 20 30 13683

Size: 200mm x 400mm

Prices:

10	£33.95
20	£19.60
30	£12.15

10 20 30 13686

10 20 30 13688

Signs for Petroleum & Flammable Substances

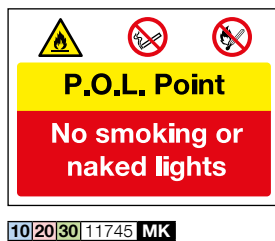

*Produced on 3mm Aluminium composite.

Vehicle Hazards

These signs have been designed for use on pillars in fuel station forecourts.

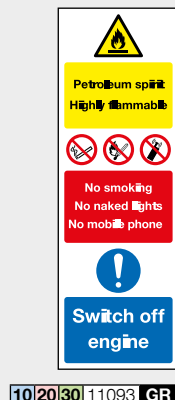
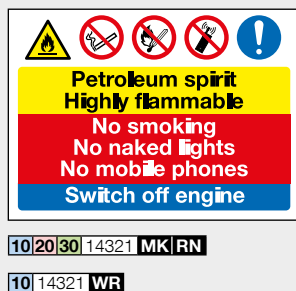

Size in mm		200x600	400x300	600x450	900x600
Size code		GR	MK	RN	WR
10	Aluminium	£18.59	£18.59	£34.76	£55.23
20	Rigid Plastic	£11.45	£11.45	£21.44	£37.25
30	Self Adhesive Vinyl	£7.27	£7.27	£10.90	-

Fire Safety Prevention

General Fire Safety and Prevention Signs



Convey safety messages clearly.

	Size in mm	75x100	150x200	200x600	210x300	250x300	300x100	400x300	400x600	600x200	600x450	900x600
	Size code	BD	FG	GR	HK	JK	KD	MK	MR	RG	RN	WR
10	Aluminium	£3.15	£7.57	£18.59	£13.14	£16.17	£7.57	£18.59	£32.83	£18.59	£34.76	£55.23
20	Rigid Plastic	£1.94	£4.42	£11.45	£7.51	£8.54	£4.42	£11.45	£20.35	£11.45	£21.44	£37.25
30	Self Adhesive Vinyl	£1.39	£2.73	£7.27	£4.91	£5.63	£2.73	£7.27	£9.57	£7.27	£10.90	-

Fire Prevention

This range of signs is especially suitable for use on garage forecourts, underground and multi storey car parks, and storage areas of highly flammable materials.



10 20 30 11010 MK | RN
10 11010 WR



10 20 30 11020 MK | RN
10 11020 WR



10 20 30 11009 MK | RN
10 11009 WR



10 20 30 12407 MK | RN
10 12407 WR



Clearly indicate hazard storage areas by marking potential danger zones.

Free-standing Sign Frames



Sign frame 720mm high, double-sided to suit 2 RN size signs

67 26154 Mild Steel £63.94
67 26154/G Galvanised Steel £93.15

Sign frame 720mm high, single-sided to suit 2 RN size signs

67 26153 Mild Steel £45.50
67 26153/G Galvanised Steel £85.72

Sign frame 420mm high to suit MK size signs

67 26151 Mild Steel £46.91
67 26151/G Galvanised Steel £76.14

All these free-standing frames are available in painted mild or plain galvanised steel. (Sign not included).



10 20 30 11019 MK | RN
10 11019 WR



10 20 30 11513 MK | RN



10 20 30 11018 MK | RN
10 11018 WR



10 20 30 11092 MK | RN



10 20 30 11008 MK | RN
10 11008 WR



10 20 30 11331 MK | RN
10 11331 WR

	Size in mm	210x210	300x400	400x300	450x600	600x450	900x600
	Size code	HH	KM	MK	NR	RN	WR
10	Aluminium	£10.96	£18.59	£18.59	£34.76	£34.76	£55.23
20	Rigid Plastic	£6.00	£11.45	£11.45	£21.44	£21.44	£37.25
30	Self Adhesive Vinyl	£4.00	£7.27	£7.27	£10.90	£10.90	-